

SVNI10C51AR

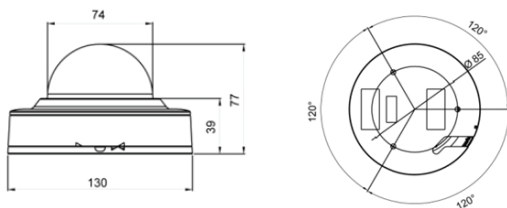

Dimensions



Product Summary

- 2 Mega pixel 1/2.8" SONY progressive scan CMOS image sensor for excellent image quality
- 2.8mm Megapixel Lens
- 30M IR Beam Distance (4 Built-in High Power LED's)
- Triple Stream
- Supports image resolution up to 2MP
- 1920(H)x 1080(V) 2MP Max. 30fps
- Supports VBR/CBR
- Controllable frame rate
- Supports WDR, 3DNR, Smart IR
- Digital PTZ
- Tool-Free 3-Axis
- 12VDC/ IEEE802.3af POE
- Conformant with ONVIF (Profile-S)
- Includes Windows based IP Installer and license-free 16 channel NVR(Network Video Recorder) software

Major Specifications

* OSD Menu is subject to change without prior notice

Model Name		SVNI10C51AR
System	CPU	ARM Cortex-A9 (816 MHz, Instruction cache : 32kbyte, data cache : 128kbyte-L2, FPU)
	Flash	256 Mbyte
	SDRAM	256 Mbyte
Camera	Image sensor	2.07 Megapixel 1/2.8" CMOS image sensor
	Total Pixels	1945(H) x 1109(V) 2.16 Megapixel
	Effective Pixels	1945(H) x 1097(V) 2.13 Megapixel
	S/N Ratio	More than 50dB
	Min. Illumination	0 Lux (IR On)
	IR Distance	30M (4 Built-in Power LED's)
	Day & Night	ICR
Video	Lens	2.8mm Megapixel Lens
	Video compression	H.265 Main profile @Level4.1 H.264 BP/MP/HP profile @Level4.1 Motion JPEG
	Resolutions	Up to 1920 x 1080 2MP
	Frame rate	Triple Stream H.265/H.264 Up to 30fps with 1920x1080p H.265/H.264 Up to 30fps with 720p H.264/MJPEG Up to 30fps with 640x480
	Video streaming	Support multi stream with H.265, H.264, MJPEG Adjustable frame rate VBR/CBR
	Pan/Tilt/Zoom	Digital PTZ
System Integration	Image setting	Day & Night Auto White Balance Auto Exposure Privacy Mask WDR/ATR 3DNR, DSS, Effect - Color, Mirror/V-Flip, etc.
	Security	Password Protection, User access log, HTTPS encryption
	Supported protocol	HTTP, HTTPS, DNS, RTSP, RTP, TCP, UDP, ICMP, DHCP
	Intelligent Video	Object based Motion detection up with 12x 12 block
	Alarm Trigger	Motion detection.
	Firmware upgrade	5MB pre-alarm and 180 sec (max) post-alarm
Physical	Etc	Remote upgrade via network
	Power Source	DC12V/1.5A, PoE(Power over Ethernet): 802.3af-Optional
	Power Consumption	Max. 4.7W with IR On
	Net Weight	250g (Camera only)
	LED's	Power, Network Connection
General	Dimension	113.8mm x 95mm
	Operating Temperature	-10 degree ~ 60 degree Celsius(-40F~140F)
Software	Included Software	NVR Lite (16 Channel), IP Installer (Windows only)