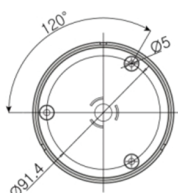
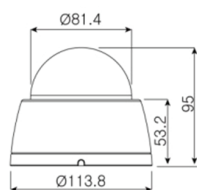

**SVNI80A54LR****Dimensions****Product Summary**

- 2 Mega pixel 1/2.9" SONY progressive scan CMOS
- 3~12mm Vari-focal Motorized Megapixel Lens
- 30M IR Beam Distance (4 Built-in High Power LED's)
- Triple Stream
- Supports image resolution up to 2MP
- Supports VBR/CBR in H.264
- Controllable frame rate
- Supports WDR, Defog, 2D+3DNR, Smart IR
- Digital PTZ / SD-CARD (Optional)
- Corridor view in H.264
- Tool-Free 3-Axis
- 12VDC/ IEEE802.3af POE
- Conformant with ONVIF (Profile-S)
- Includes Windows based IP Installer and license-free 16 channel NVR(Network Video Recorder) software

**Major Specifications**

\* OSD Menu is subject to change without prior notice

MODEL	SVNI80A54LR
CPU	ARM1176JZF-S (400 MHz, Instruction cache: 32kbyte, data cache
Flash	2Gbit Flash memory
SDRAM	2Gbit DDR3
Image sensor	2.0 Mega 1/2.9" SONY progressive scan CMOS
Total Pixels	1952(H) x 1116(V) 2.18 Megapixel
Effective Pixels	1944(H) x 1104(V) 2.14 Megapixel
S/N Ratio	More than 50dB
Min. Illumination	0 Lux (IR On)
IR Distance	30M (4 Built-in Power LED's)
Day & Night	ICR
Lens	3~12mm Vari-focal Motorized Megapixel Lens
Video compression	H.264 High Profile@4.0, MJPEG-Image quality: 3 Steps
Resolutions	Up to 1920 x 1080 2MP
Frame rate	Triple Stream 1st stream: 30fps@1920x1080 / FULL HD 2nd stream: 30fps@1280x720 / HD 3rd stream: 30fps@640x480
Video streaming	Triple stream with H.264/MJPEG, Adjustable frame rate, CBR/VBR in H.264
Pan/Tilt/Zoom	Digital PTZ
Corridor view	Corridor view in H.264 (90degree/ 270degree)
Image setting	Brightness, contrast, Sharpness Day & Night Auto White Balance Auto Exposure Privacy Mask DSS, Effect - Color, Mirror/V-Flip, etc.
Security	Password Protection, User access log, HTTPS encryption
Supported protocol	HTTP, HTTPS, FTP, SMTP, UPnP, DNS, DDNS, NTP, RTSP, RTP, TCP, UDP, ICMP, DHCP
Intelligent video	Object based Motion detection up with 12x 12 block Tamper detection with Global scene change and defocus.
Alarm events	File upload via ftp, E-mail, Notification via email, SD Card.
Video buffer	5MB pre-alarm and 180 sec (max) post-alarm
Firmware upgrade	Remote upgrade via network
API	CGI Interface document, ActiveX Interface(ocx(dll) + document)
Power Source	DC12V/1.5A, PoE(Power over Ethernet): 802.3af-Optional
Power Consumption	Max. 6.5W with IR On
Net Weight	280g (Camera only)
LED's	Power, Network Connection
Dimension	113.8mm x 95mm
Operating Temperature	-10 degree~50 degree Celsius(14F~122F)
Included Software	NVR C/S (16 Channel), IP Installer (Windows only)