

# SVNP30S55XR

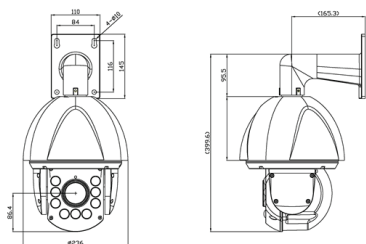

## Dimensions



## Product Summary

- 2 Megapixel Full HD
- Built-in Fan/Heater
- 30x Auto Focus (f4.3~129mm)
- Total 360x Zoom (12x Digital Zoom)
- 200M IR distance
- IR sync with Zoom (10 levels) and IR On/Off
- WDR (Low/Middle/High)
- Integrated motion detection with pre- and post alarm image/video buffering
- Event-triggered FTP and email upload of still images and videos
- Full Duplex two way Audio support
- UPnP supported
- External sensors or external alarm devices
- Supports CBR(constant bit rate) and VBR (variable bit rate) modes
- Integrated HTTP Web server supporting 50 simultaneous users connection
- HTTPS supported (Hyper Text Transfer Protocol Secured)

## Major Specifications

\* OSD Menu is subject to change without prior notice

Model	SVNP30S55XR	
Camera	Image sensor	1/2.8" Type " Exmor R" CMOS Sensor
	Day & Night	True Day/Night (ICR)
	Environment	IP66
	Optical Zoom	30X
	Digital Zoom	12X
	Lens	30x AF zoom ( f4.3~129mm )
	IR Distance	200M
	Min. illumination	0 Lux with IR
	Pan / Tilt	Pan: 360 Endless , Tilt: -0~90 deg (Auto flip) PAN/TILT Speed: Preset 250deg/Sec,Manual 0.1~120deg/Sec
	WDR	Low/Middle/High
Video	Noise Reduction	2D+3DNR
	White Balance	Auto,ATW,Indoor,Outdoor,Onepush WB,Manual WB,Outdoor Auto
	Compression	H.264 High Profile @Level5.0 @Level4.1(Other resolutions), Motion JPEG
	Resolutions	Up to 1920 x 1080
Video	Frame rate	H.264 Up to 30fps with FULL HD 1920x1080 H.264 Up to 30fps with HD, MJPEG Up to 30fps with VGA resolution.
	Video streaming	Support multi stream with H.264, MJPEG, H.264+H.264+MJPEG Triple Adjustable frame rate, VBR/CBR in H.264
	Image setting	Day & Night, Auto White Balance, Auto Exposure, Privacy Mask, D-WDR, 2DNR/3DNR,DSS,Mirror/V-Flip, Corridor-View(in H.264)
Audio	Audio streaming	Two-way, full duplex
	Compression	G.711
	Sample Rate	8KHZ
	Data Rate	64Kbps
Control	Audio input	Microphone input /1 x Line-In (Mono)
	Audio output	Line output/ 1 x Line-Out (Mono)
Network	RS-485	1PORT
	Security	Password protection/ User access log / HTTPS encryption
System integration	Supported protocol	HTTP, HTTPS, FTP, SMTP, UPnP, DNS, DynDNS, NTP, RTSP, RTP, TCP, UDP, ICMP, DHCP,SNMP,IP Filter
	Intelligent video	Motion detection up to 1920x1080 with 12x12 blocks
	Alarm trigger	Motion detection (4 x Sensor in, 2 x Alarm out)
	Alarm events	File upload via ftp, E-mail, Notification via Email, FTP and TCP
	Video buffer	5MB pre-alarm and post-alarm-180sec
	Recording	Save to MicroSD/SDHC card with event mode and continuous mode
	Firmware upgrade	Remote upgrade via network
Physical	API	CGI Interface document, ActiveX Interface(ocx(dll) + document)
	RESET Button	1 x Factory Reset Button (SIDE)
	Power Source	AC24V 2.5A
	Power Consumption	Normal: 13W, IR ON: MAX 35W(VA)
	Weight (Appr.)	4,500g
Environment	LED's	Network Connection
	Dimension(mm)	236mm X 399.6
	Operating Temp.	-25 degree~50 degree Celsius (-13F~122F)
Software	Storage Temp.	-30 degree~60 degree Celsius (-22F~140F)
	Included Software	NVR C/S (16 Channel), IP Installer (Windows Only)
Package Contents	Network Camera, User Manual, Software CD, External Power Adaptor (optional)	